

## AXIAL TAPING, STANDARD

### DIMENSIONS T-TYPE

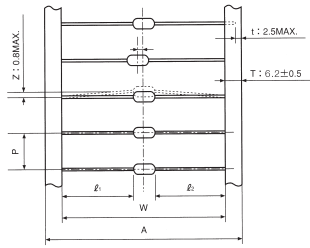

TYPE	W	P	A	h <sub>1</sub> -h <sub>2</sub>	ACCUMULATED TOLERANCE
T26	26 <sup>+0.2</sup> <sub>-0</sub>	5.00 ± 0.3	39 ± 1.0	0.2 Max.*	250.0 ± 3 mm/P x 50
	26 <sup>+1</sup> <sub>-0</sub>	5.00 ± 0.3	39 ± 1.0	1.0 Max.	100.0 ± 2 mm/P x 20
T52	52 ± 1	5.08 ± 0.38	65 ± 1.0	1.0 Max.	101.6 ± 2 mm/P x 20
T521	52 ± 1	10.16 ± 0.80	65 ± 1.0	1.0 Max.	203.2 ± 3 mm/P x 20
T631	63 ± 1	10.16 ± 0.80	-	1.0 Max.	203.2 ± 3 mm/P x 20
T74	74 ± 1	5.08 ± 0.38	-	1.0 Max.	101.6 ± 2 mm/P x 20
T741	74 ± 1	10.16 ± 0.80	-	1.0 Max.	203.2 ± 3 mm/P x 20

\* CFS1/4 (CFPS1/4) T26 only

### DIMENSIONS L-TYPE

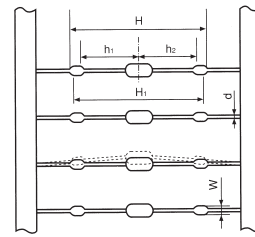

TYPE	H±1	W	d	h <sub>1</sub> • h <sub>2</sub>
MO(X) 1/2 L52	25.5	1.20 ... 1.45	0.8	h <sub>1</sub> - h <sub>2</sub>   ≤ 1
MO(X) 1 L521	36.0		0.8	
MO(X) 2 L631	42.5	0.8		
MOS(X) 1 L52	25.5	0.8		
MOS(X) 2 L521	36.0	0.8		
MOS(X) 3 L631	42.5	0.8		
SPR(X) 1/2 L52	26.0	1.17 ... 1.40	0.65	
SPR(X) 1 L521	25.5	0.8		
SPR(X) 2 L521	36.0	0.8		
SPR(X) 3 L521	36.0	1.20 ... 1.45	0.8	
SPR(X) 3 L631	42.5	0.8		
CFP 1/4 L52	H1: 24.5 ± 1	1.17 ... 1.4	0.65	
CFPB 1/2 L52	H1: 27.5 ± 1			
CW 1/2 L52	26.0	1.05 ... 1.35	0.6	
CW 1 L52	27.5	1.20 ... 1.40	0.8	

TAPING TYPE NAME	PACKAGING & Q'TY (pcs)		WEIGHT (g)		
	AMMO	REEL	AMMO	REEL	NET 1000pcs
CFS1/4CT26	5000	-	615	-	110
CFS1/4CT52	3000	5000	530	920	150
CF1/4CT26	2000	-	410	-	180
CF1/4CT52	2000	5000	530	1400	240
CFB1/2CT52	2000	4000	1110	2280	520
CFS1/2CT26	2000	-	525	-	230
CFS1/2CT52	2000	4000	640	1500	290
CFPS1/4CT26	5000	-	615	-	100
CFPS1/4CT52	3000	-	530	-	150
CFP1/4CT26	2000	-	410	-	180
CFP1/4CT52	2000	5000	530	1400	240
CFP1/4CL52	2000	-	530	-	240
CFPB1/2CT52	2000	4000	1110	2280	520
CFPB1/2CL52	2000	-	1110	-	520
CFPS1/2CT26	2000	-	525	-	230
CFPS1/2CT52	2000	4000	640	1500	290
MFS1/4 CT26	3000	-	350	-	90
MFS1/4 CT52	3000	-	500	-	120
MF1/4 CT26	2000	-	360	-	160
MF1/4 CT52	2000	5000	500	1300	215
MFS1/2 CT26	2000	-	360	-	160
MFS1/2 CT52	2000	5000	500	1300	215
MF1/2 CT52	2000	4000	900	2000	360
MFP1/4 CT26	2000	-	450	-	250
MFP1/4 CT52	2000	5000	470	1400	250
MFP1/2 CT52	2000	4000	950	2010	430
SNF2CC26	3000	-	500	-	110
SNF2CC52	3000	-	430	-	150
SNF2ECT26	2000	-	450	-	180
SNF2ECT52	2000	5000	470	1400	240
SNF2HCT52	2000	4000	950	2010	520
RNS1/8 CT52	2000	5000	600	1550	220
RNS1/4 CT52	2000	4000	600	1550	440
RNS1/2 CT52	2000	4000	1110	2150	520
RNS1 CT521	500	1000	750	2100	1300
RK1/4 CT26	2000	-	360	-	250
RK1/4 CT52	2000	5000	500	1300	250
RK1/2 CT52	2000	-	900	-	380
RK1 CT521	500	-	700	-	1340
Z16CT26	5000	-	615	-	110
Z16CT52	3000	5000	530	920	150
Z25CT26	2000	-	410	-	180
Z25CT52	2000	5000	530	1400	240
J1/6ZCT26	2000	-	230	-	90
J1/6ZCT52	2000	5000	320	950	130
J1/4ZCT26	2000	-	320	-	130
J1/4ZCT52	2000	5000	460	1310	190
JL6CT26	5000	-	515	-	100
JL6CT52	5000	-	815	-	160
SPR(X)1/4CT26	2000	-	250	-	90
SPR(X)1/4CT52	2000	5000	340	850	140
SPR(X)1/2CT26	2000	-	350	-	140
SPR(X)1/2CT52	2000	5000	590	1400	250
SPR(X)1/2CL52	2000	5000	590	1400	250
SPR(X)1CT52	2000	4000	1140	2150	500
SPR(X)1CL52	2000	4000	1140	2150	500
SPR(X)2CT52	1000	2000	910	1750	800
SPR(X)2CL521	1000	1000	910	950	800
SPR(X)3CT521	500	1000	765	1500	1350
SPR(X)3CT631	1000	1000	1580	1600	1400
SPR(X)3CL631	1000	1000	1580	1600	1400
SPR(X)3CT741	1000	-	1620	-	1400

### ORDERING CODE

T26	A
TAPING	PACKAGING
T: tape	A: taped in ammpack (box)
52.: width between tapes in mm	R: taped on reel

Contact our sales representatives before you use our products for applications including automobiles, medical equipment and aerospace equipment. Malfunction or failure of the products in such applications may cause loss of human life or serious damage.

Specifications given herein may be changed at any time without prior notice. Please confirm technical specifications before you order or use.

T.C.R symbol is entered in the □.

## AXIAL TAPING, STANDARD

TAPING TYPE NAME	PACKAGING & Q'TY (pcs)		WEIGHT (g)		
	AMMO	REEL	AMMO	REEL	NET 1000pcs
MOS(X)1/2CT26	2000	-	350	-	140
MOS(X)1/2CT52	2000	5000	590	1400	250
MOS(X)1CT52	2000	4000	810	1550	350
MOS(X)1CT528	2000	4000	810	1550	350
MOS(X)1CL52	2000	4000	810	1550	350
MOS(X)1CT74	2000	2000	-	-	350
MOS(X)2CT52	1000	2000	910	1750	800
MOS(X)2CT521	1000	1000	910	1750	800
MOS(X)2CL521	1000	1000	910	950	800
MOS(X)2CT74	1000	-	-	-	800
MOS(X)2CT741	1000	-	-	-	800
MOS(X)3CT521	500	1000	775	1500	1350
MOS(X)3CT631	1000	1000	1580	1600	1400
MOS(X)3CL631	1000	1000	1580	1600	1400
MOS(X)3CT741	1000	-	1620	-	-
MO(X)1/2CT52	2000	4000	1100	2070	480
MO(X)1/2CL52	2000	4000	1100	2070	480
MO(X)1CT52	1000	2000	910	1750	800
MO(X)1CT521	1000	-	910	-	800
MO(X)1CL521	1000	-	910	-	800
MO(X)1CT631	1000	-	750	-	800
MO(X)1CT74	2000	2000	-	-	800
MO(X)1CT741	1000	-	-	-	800
MO(X)2CT521	500	1000	775	1500	1350
MO(X)2CT631	1000	1000	1580	1600	1400
MO(X)2CL631	1000	1000	1580	1600	1400
MO(X)2CT741	1000	-	1620	-	1400
HPC1/2CT52	1000	2000	800	1440	600
HPC1/2CT521	1000	-	-	-	660
HPC1/2CT74	2000	-	1500	-	700
HPC1/2CT741	1000	-	-	-	700
HPC1CT631	-	1000	-	1440	1170
PCF1/2CT52	-	2000	-	1140	450
PCF1CT631	-	1000	-	1530	1270
PCF2CT631	-	500	-	1340	2160
RCR16CT26	5000	-	500	-	100
RCR16CT52	3000	-	450	-	150
RCR25CT26	2000	-	390	-	180
RCR25CT52	2000	-	520	-	240
RCR50(+/-EN)CT52	2000	-	1050	-	520
RCR60CT52	2000	-	1050	-	520
RCR75CT52	1000	-	830	-	800
RCR100CT521	500	-	750	-	1400
RCR100CT631	1000	-	1450	-	1400
GS1/4CT52	2000	-	810	-	320
GS1/2CT52	1000	-	750	-	590
CW1/4CT26	2000	-	500	-	150
CW1/4CT52	3000	-	430	-	150
CW1/2CT52	2000	-	480	-	250
CW1CT52	1000	-	600	-	650
CW1SCT52	2000	-	480	-	250
CW2CT52	1000	-	780	-	950
CW2CT521	1000	-	800	-	950
CW3CT521	500	-	750	-	1780
CW3CT631	500	-	750	-	1780
LT1/6CT26	3000	-	350	-	90
LT1/6CT52	3000	5000	500	900	120
LT1/4CT26	2000	-	360	-	160
LT1/4CT52	2000	5000	500	1300	215
LP1/8CT26	2000	-	410	-	170
LP1/8CT52	2000	-	580	-	260
LP1/16CT26	4000	-	450	-	100
LP1/16CT52	4000	-	630	-	150
SDT101AXCT26	2000	-	350	-	75
SDT101AXCT52	2000	-	470	-	105
RF16CT26	2000	-	220	-	90
RF16CT52	2000	5000	340	800	150
RF25CT26	2000	-	330	-	140
RF25CT52	2000	5000	500	1300	230
RF50CT52	2000	4000	660	1320	310
RF1CT52	2000	4000	1080	2050	500
RF2CT521	500	1000	700	1420	1300
RF2CT631	1000	-	1410	-	1350
SA05CT52	2000	-	420	-	160

### ORDERING CODE

T52	A
TAPING	PACKAGING
T: tape	A: taped in ammpack (box)
52: width between tapes in mm	R: taped on reel

Contact our sales representatives before you use our products for applications including automobiles, medical equipment and aerospace equipment. Malfunction or failure of the products in such applications may cause loss of human life or serious damage.

Specifications given herein may be changed at any time without prior notice. Please confirm technical specifications before you order or use.